

Thank you for buying our product

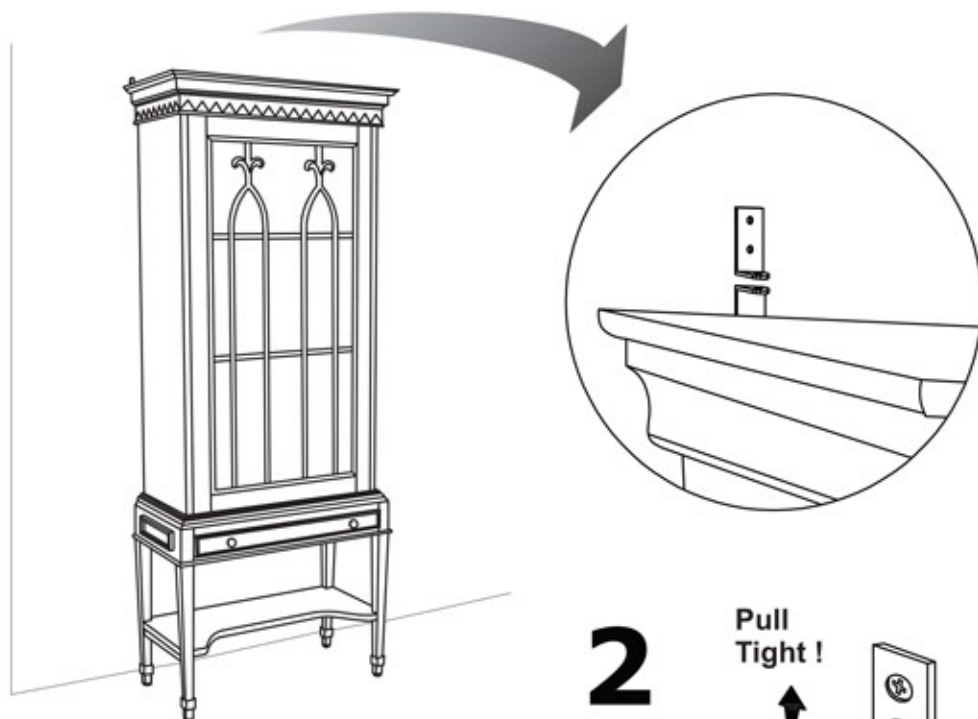

Step By Step Assembly Instructions

PRE-ASSEMBLY PREPARATION

1. Please check the pack contents before attempting this product.
A full checklist of component is given in this leaflet. If any component are missing, please contact the retailer from whom you bought this product.
2. This product is **heavy**, it should be assembled as near as possible to the point of use.
TAKE CARE WITH LIFTING to avoid personal injury and (or) damage to the product.
3. This product takes approximately 5 minutes to assemble with 2 people.
4. The fitting pack contains **small items** which should be :
KEPT AWAY FROM YOUNG CHILDREN.
5. Read this leaflet in full before commencing assembly.
6. You will require a crosshead screwdriver and Allen key (provided) to assemble this product.
7. **WE RECOMMEND** that you lay a protective cloth on your carpet during assembly, **to prevent marking.**



1

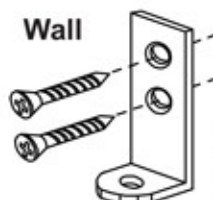

Use a wall fixing suitable for your wall type !

E.g Rawl plug,
Plasterboard fixing etc

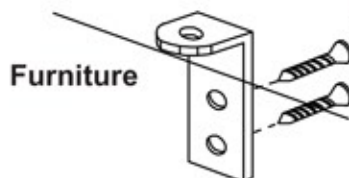

2

Pull Tight !

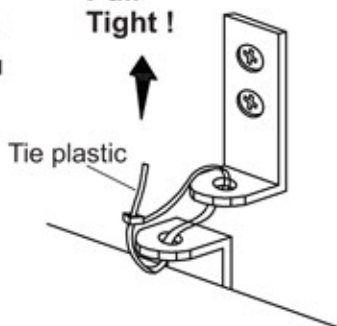

HARDWARE

Screw \varnothing 8 x 2" (4 pcs)
 \varnothing 8 x 3/4" (4 pcs)



"L" Brackets (2 set)



Tie plactic (2 pcs)



Step 1. Base Cabinet & Display Cabinet Assembly

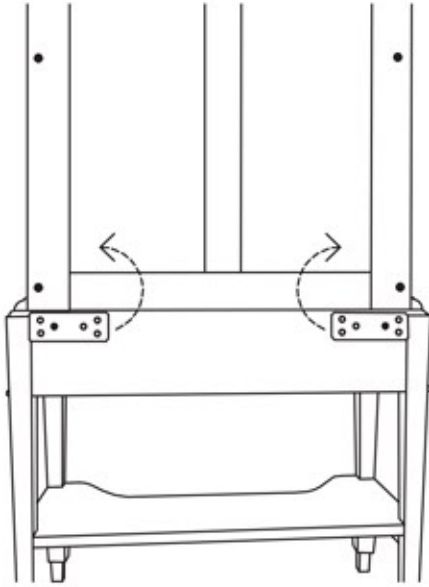

**A. Left turn for the cleat on the back panel
(Please see the picture)**

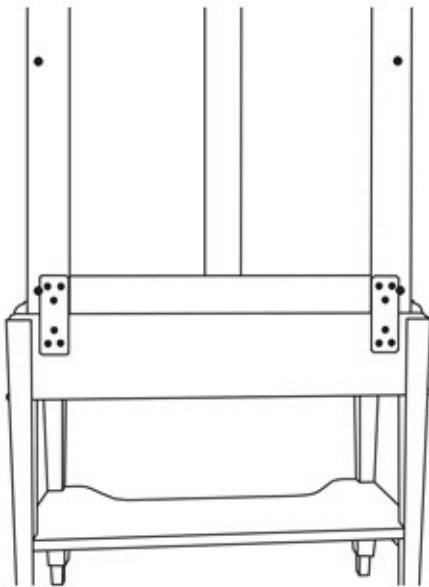
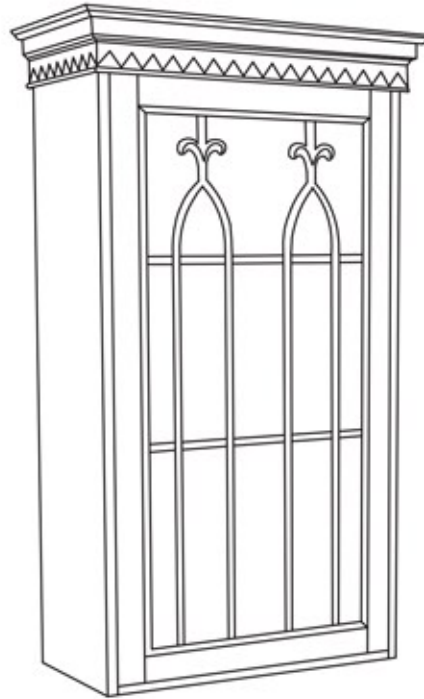

**B. Fixed the cleat with screws .
(Please see the picture)**



3. Back Panel Assembly

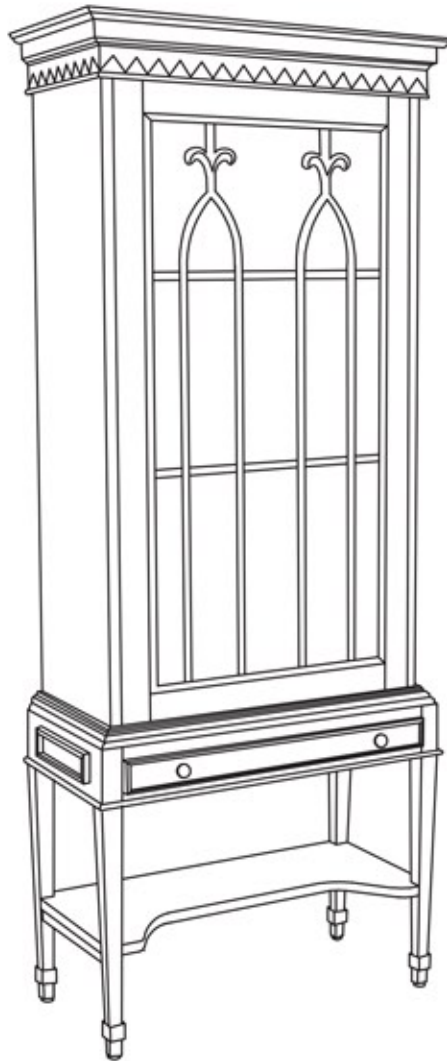

DONE !